

SPECIFICATIONS

CONTACT RATING : Dependent upon contact material See page 29.

ELECTRICAL LIFE : 30,000 make-and-break cycles at full load.

CONTACT RESISTANCE : 20mΩ max. initial @ 2-4 VDC. 100 mA for both silver and gold plated contacts.

INSULATION RESISTANCE : 1,000 MΩ min.

DIELECTRIC STRENGTH : 1,000 V RMS min. @ sea level.

OPERATING TEMPERATURE : -30°C to 130°C.

MATERIALS

CASE : Diallyl phthalate (DAP)(UL94V-0).

ACTUATOR : Brass, chrome plated.

BUSHING : Brass, nickel plated.

HOUSING : Stainless steel.

SWITCH SUPPORT : Brass,tin plated.

TERMINAL/CONTACT : Silver or gold plated. See page 29.

TERMINAL SEAL : Epoxy

NO. POLES	MODEL NO.	SWITCH FUNCTION			CONNECTED TERMINALS/SCHEMATIC		
		POS.1	POS.2	POS.3	POS.1	POS.2	POS.3
SP	DS-40	ON	NONE	OFF		OPEN	
	DS-41	ON	NONE	ON	2-3		
	DS-42	ON	NONE	MOM			
	DS-43	ON	OFF	ON			
DP	DS-51	ON	NONE	ON	2-3,5-6	OPEN	2-1,5-4
	DS-52	ON	NONE	MOM			
	DS-53	ON	OFF	ON			

MOM=MOMENTARY

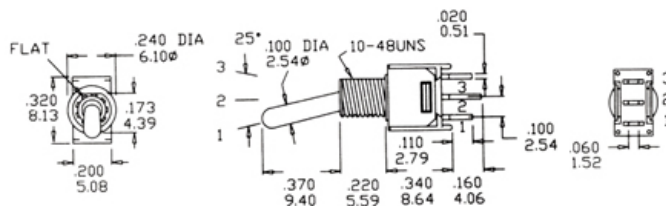

SPDT Part No.DS-41T1B1A1QN

DS500 Series

Sub-Miniature Toggle Switches

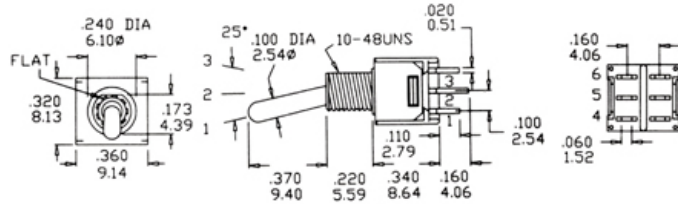

DPDT Part No.DS-51T1B1A1QN

A3

P.C. MOUNTING

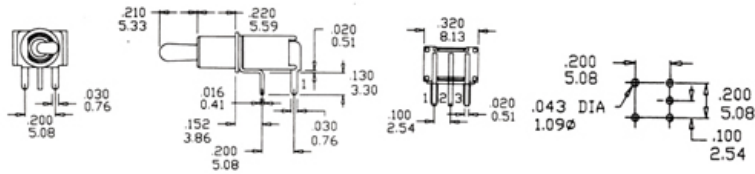

SPDT Part No.DS-41T2B2A3QN

A3

P.C. MOUNTING

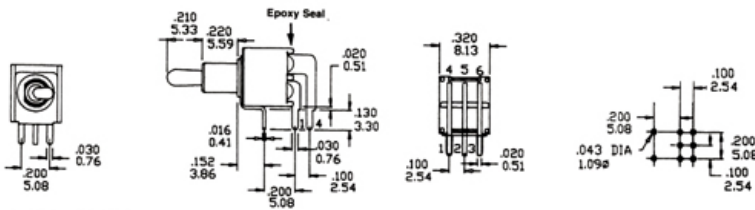

DPDT Part No.DS-51T2B2A3QE

A4

P.C. MOUNTING

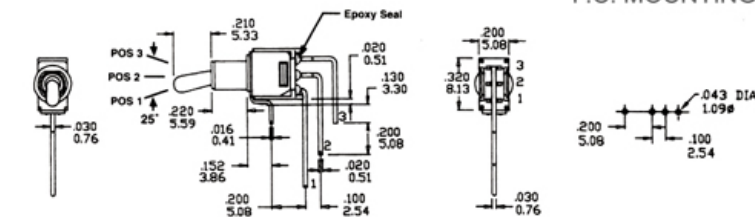

SPDT Part No.DS-41T2B2A4QE

A4

P.C. MOUNTING

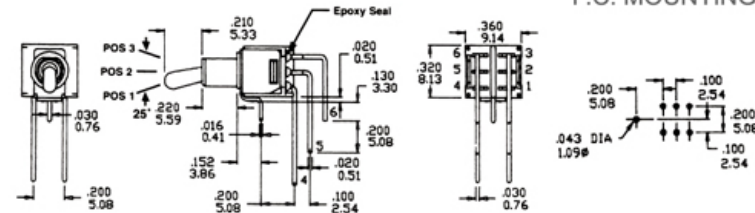

DPDT Part No.DS-51T2B2A4QE

DS500 Series

Sub-Miniature Toggle Switches

VS1

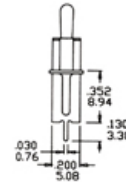
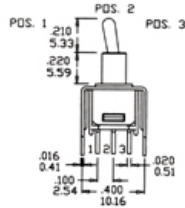

P.C. MOUNTING

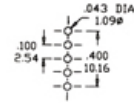

SPDT Part No. DS-41T2B2VS1QN

VS1

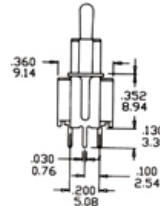
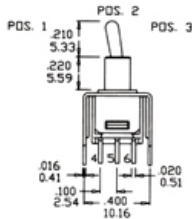

P.C. MOUNTING

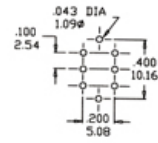

DPDT Part No. DS-51T2B2VS1QN

ACTUATOR OPTIONS

T1

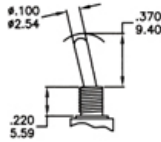

T2

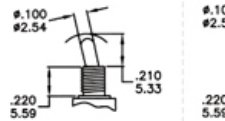

T3

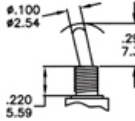

T4

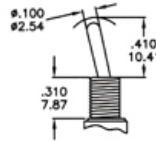

T5

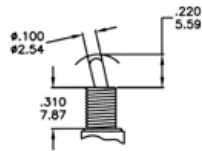

BUSHING OPTIONS

B1 THD
B2 NON-THD

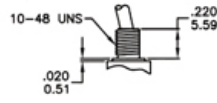
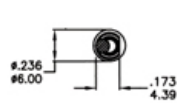

B3 THD
B4 NON-THD

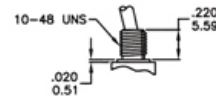
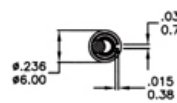

B5 THD
B6 NON-THD

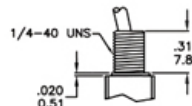
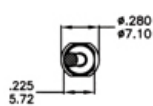

B7 THD
B8 NON-THD

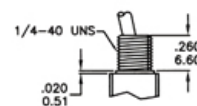
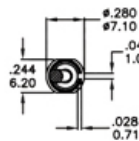

DS500 Series

Sub-Miniature Toggle Switches

TERMINATION OPTIONS

A1

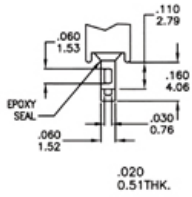

A2

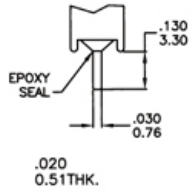

A3

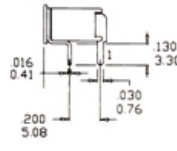

A4

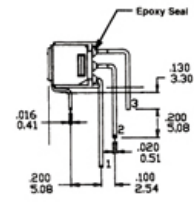

CONTACT RATING

Q

FIXED TERMINAL : Silver plated over copper alloy

MOVING CONTACT : Silver plated over copper alloy

RATING : 3 Amps with resistive load@120VAC or 28VDC
1.5 Amps with resistive load@250VAC

G

FIXED TERMINAL : Copper alloy with gold plated over nickel plate

MOVING CONTACT : Copper alloy with gold plated over nickel plate

RATING : 0.4 Volt-Amps(VA) max. @20V max. (AC or DC)



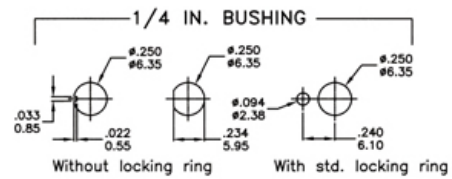
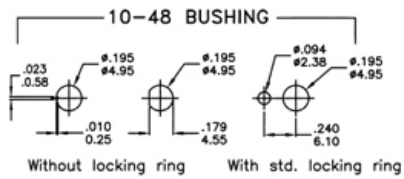

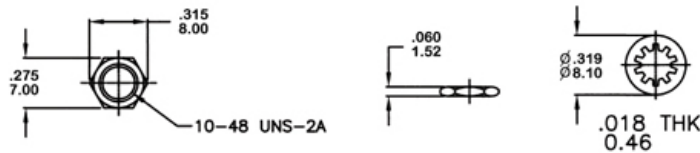

PANEL MOUNTING



HARDWARE



HOW TO ORDER

MODEL NO.	ACTUATOR	BUSHING	TERMINATIONS	CONTACT MATERIAL	SEAL
					
DS-40 DS-41 DS-42 DS-43 DS-51 DS-52 DS-53	T1 T2 T3 T4 T5	B1 B2 B3 B4 B5 B6 B7 B8	A1 A2 A3 A4 VS1	Q=Silver G=Gold	E=EPOXY N=NO EPOXY