

# B400 Series

## Snap-Acting Pushbutton Switches

### SPECIFICATIONS

**CONTACT RATING** : Dependent upon contact material See page 25.

**ELECTRICAL LIFE** : 50,000 make-and-break cycles at full load.

**CONTACT RESISTANCE** : 10mΩ max. initial @ 2-4 VDC. 100 mA for both silver and gold plated contacts.

**INSULATION RESISTANCE** : 1,000 MΩ min.

**DIELECTRIC STRENGTH** : 1,000 V RMS min. @ sea level.

**OPERATING TEMPERATURE** : -30°C to 130°C.

### MATERIALS

**CASE** : Diallyl phthalate (DAP)(UL94V-0).

**ACTUATOR** : Glass filled Nylon or Glass filled Polyester.

**BUSHING** : Brass, nickel plated.

**HOUSING** : Stainless steel.

**SWITCH SUPPORT** : Brass,tin plated.

**TERMINAL/CONTACT** : Silver or gold plated. See page 25.

**TERMINAL SEAL** : Epoxy

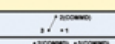
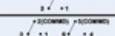
NO. POLES	MODEL NO.	SWITCH FUNCTION		CONNECTED TERMINALS		SCHEMATIC
		POS.1	POS.2	POS.1	POS.2	
SP	B101	ON	ON	2-3	2-1	
DP	B201	ON	ON	2-3,5-6	2-1,5-4	



SPDT Part No.B101P1B1A1QE

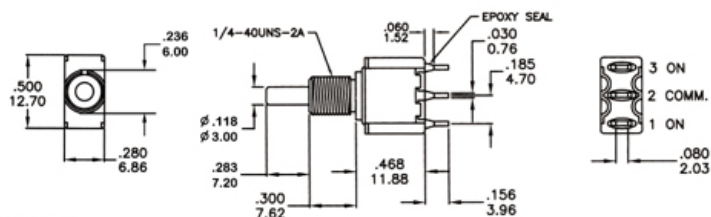

DPDT Part No.B201P1B1A1QE

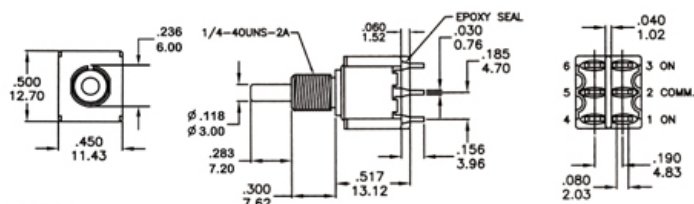

# B400 Series

# Snap-Acting Pushbutton Switches

## A3

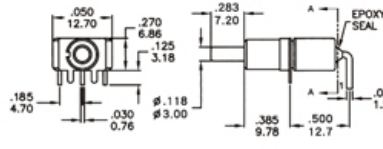

### P.C. MOUNTING

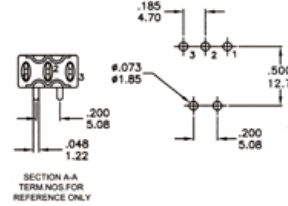

SPDT Part No.B101P1B2A3QE

## A3

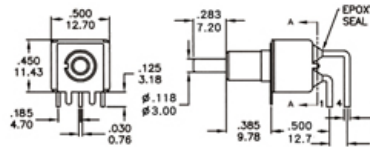

### P.C. MOUNTING

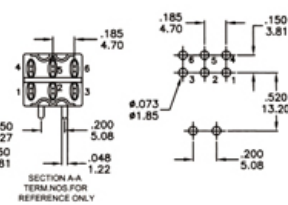

DPDT Part No.B201P1B2A3QE

## A4

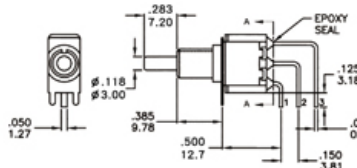

### P.C. MOUNTING

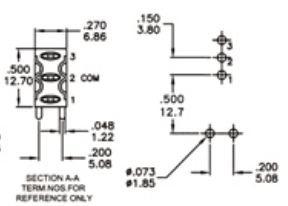

SPDT Part No.B101P1B2A4QE

## A4

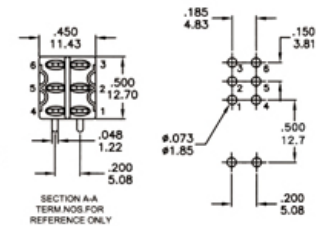
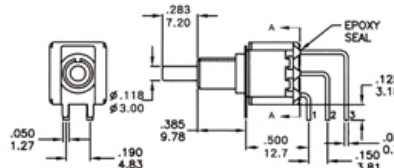

DPDT Part No.B201P1B2A4QE

## ACTUATOR OPTIONS

P1

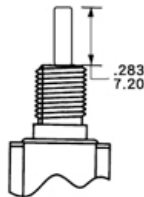

P2

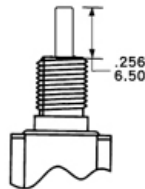

P3

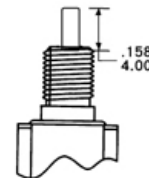

# B400 Series

## Snap-Acting Pushbutton Switches

### BUSHING OPTIONS

B1 THD STD  
B2 NON-HD

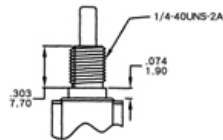
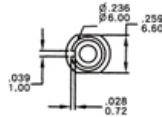

B3 THD STD  
B4 NON-HD

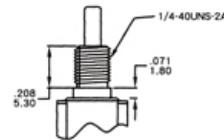
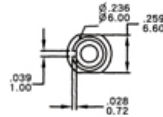

B5 THD STD  
B6 NON-HD

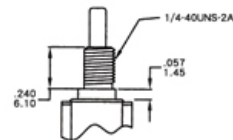
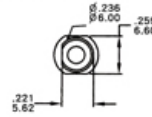

### TERMINATION OPTIONS

A1 STD

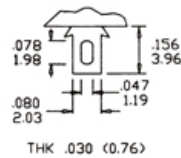

A2

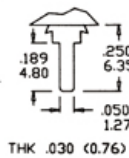

A3

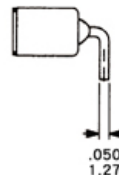

A4

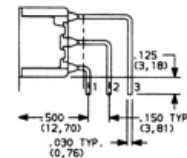

### CONTACT RATING

**Q**

**FIXED TERMINAL :** Silver plated over copper alloy

**MOVING CONTACT :** Silver plated over copper alloy

**RATING :** 5 Amps with resistive load@120VAC or 28VDC

2 Amps with resistive load@250VAC

**G**

**FIXED TERMINAL :** Copper alloy with gold plated over nickel plate

**MOVING CONTACT :** Copper alloy with gold plated over nickel plate





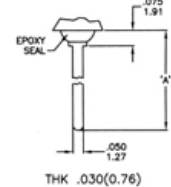

**RATING :** 0.4 Volt-Amps(VA) max. @20V max. (AC or DC)

A5



OPTION CODE	DIM. 'A'
A5-1	.700(17.80)
A5-2	.744(17.80)

### HOW TO ORDER

MODEL NO.	ACTUATOR	BUSHING	TERMINATIONS	CONTACT MATERIAL	SEAL
 B101 B201	 P1 P2 P3	 B1 B2 B3 B4 B5 B6	 A1 A2 A3 A4 A5-1 A5-2	 Q=Silver G=Gold	 E=EPOXY N=NO EPOXY